

CAMPASPE SHIRE COUNCIL

ECHUCA RIVERFRONT

FUNCTIONAL DESIGN - ACCESS RAMP & WALKWAY MODIFICATIONS

LOCATION:
ECHUCA, VIC

CONCEPT
NOT FOR CONSTRUCTION



RELEASE DETAILS

REV	DESCRIPTION	DATE	DOCUMENT STATUS	APP.
P2	CONCEPT (NOT FOR CONSTRUCTION)	12.07.21	CONCEPT	RH
P1	CONCEPT (NOT FOR CONSTRUCTION)	02.07.21	CONCEPT	RH

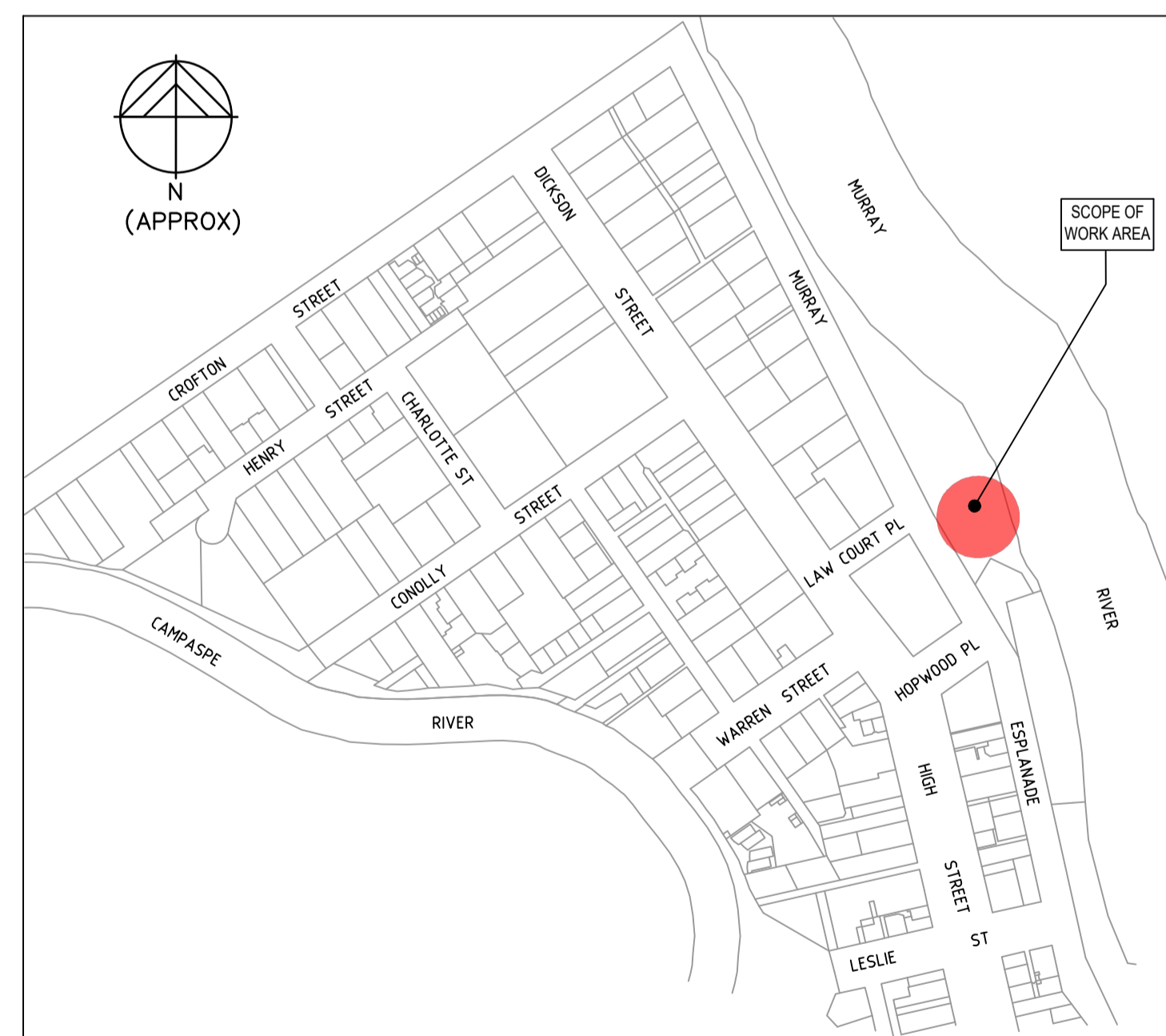

SITE LOCALITY
SCALE: N.T.S.

Project No.: 21051

Drawing Number	Sheet Number	Plan Title
21051_01	1	COVER PLAN & DRAWING INDEX
21051_02	2	PROPOSED VIEWING PLATFORM ACCESS RAMP
21051_03	3	PROPOSED WALKWAY MODIFICATIONS
21051_04	4	PROPOSED WALKWAY LONGITUDINAL SECTION

NOTES:

HEIL ENGINEERING CONSULTANTS HAVE BEEN ENGAGED BY CAMPASPE SHIRE COUNCIL TO PREPARE A FUNCTIONAL DESIGN FOR THE PROPOSED ACCESS RAMP AND WALKWAY MODIFICATIONS ONLY. THESE PLANS ARE NOT TO BE USED FOR CONSTRUCTION AND ARE SUBJECT TO DETAILED DESIGN INCLUDING STRUCTURAL DESIGN, GEOTECHNICAL DESIGN AND OTHER RELEVANT SPECIALIST REPORTS AND ASSESSMENTS THAT MAY BE REQUIRED TO OBTAIN STAKEHOLDER APPROVAL.

LEGEND

EXISTING	
CENTERLINE	
EDGE OF PATH	
SIGN POST	
TREE / SHRUB	
TOP OF BANK	
INVERT OF SWALE	
GABION ROCK WALL	
STORMWATER PIT / PIPE	
PROPOSED	
PROPOSED WALKWAY / RAMP	
DDA COMPLAINT HANDRAIL	
FINISHED SURFACE LEVEL	

CONCEPT
NOT FOR CONSTRUCTION

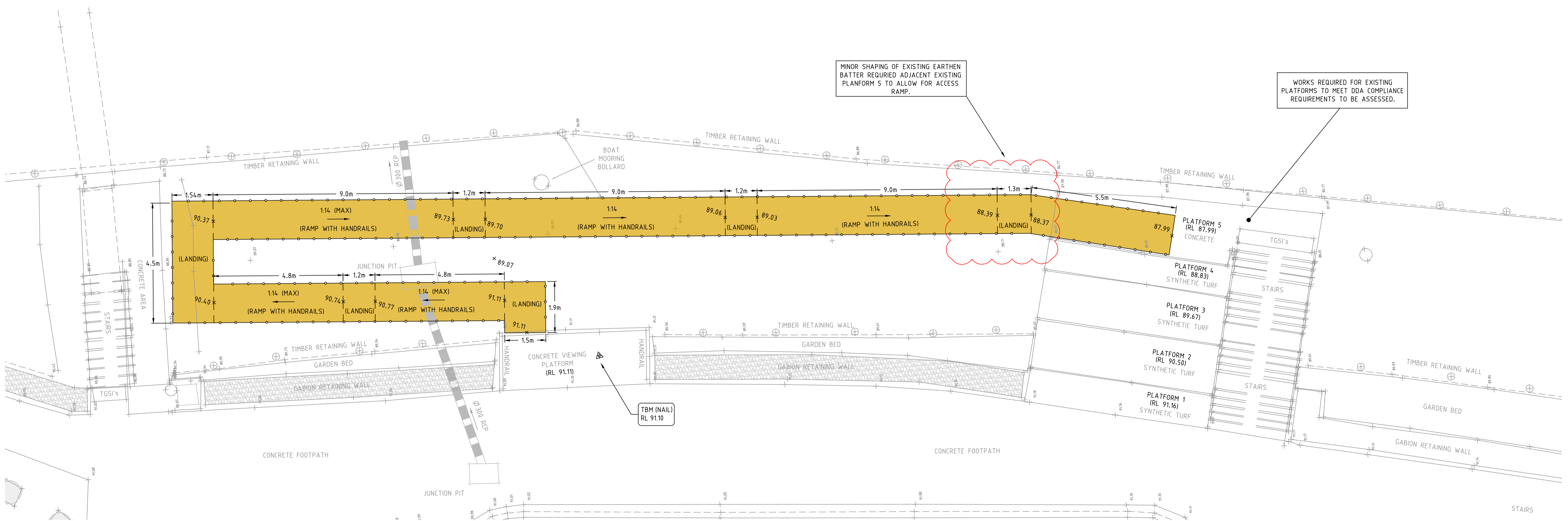

**FUNCTIONAL DESIGN
PROPOSED VIEWING PLATFORM ACCESS RAMP**
SCALE: 1:50

RELEASE DETAILS

NO.	DESCRIPTION	DATE	DOCUMENT STATUS	APP.
P3	PRELIMINARY	30.08.21	PRELIMINARY	RH
P2	PRELIMINARY	12.07.21	PRELIMINARY	RH
P1	PRELIMINARY	02.07.21	PRELIMINARY	RH



SWAN HILL, VIC 3585 P. 03 50332189
OCEAN GROVE, VIC 3226 P. 03 52552220 www.heconsult.com.au
DESIGNED RH JULY 21
DRAWN RH JULY 21

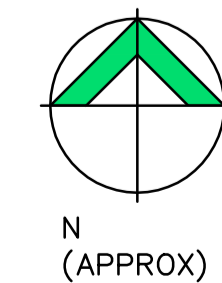

0 0.5 1.0 2.0
Scale 1:50

CAMPASPE SHIRE COUNCIL
FUNCTIONAL DESIGN - ACCESS RAMP & WALKWAY MODIFICATIONS

ECHUCA RIVERFRONT
ECHUCA, VIC
**PROPOSED VIEWING PLATFORM
ACCESS RAMP (SWITCH-BACK OPTION)**

DRAWING NO. 21051_02.1
SHEET NO. 02 of 04

REVISION NO. P3
A1
CAD: 21051_SD01-04.dwg

© Heil Engineering Consultants P/L
THIS DOCUMENT IS COPYRIGHT AND MAY ONLY BE USED FOR THE PURPOSE FOR WHICH IT WAS COMMISSIONED.
UNAUTHORIZED USE PROHIBITED. ALL DIMENSIONS AND LEVELS TO BE CHECKED ON THE PROJECT BEFORE
COMMENCING ANY WORKS OR SHOP DRAWINGS. DRAWINGS NOT TO BE SCALED.

LEGEND

EXISTING	PROPOSED
CENTERLINE	PROPOSED WALKWAY / RAMP
EDGE OF PATH	FINISHED SURFACE LEVEL
SIGN POST	
TREE / SHRUB	
TOP OF BANK	
INVERT OF SWALE	
GABION ROCK WALL	
STORMWATER PIT / PIPE	

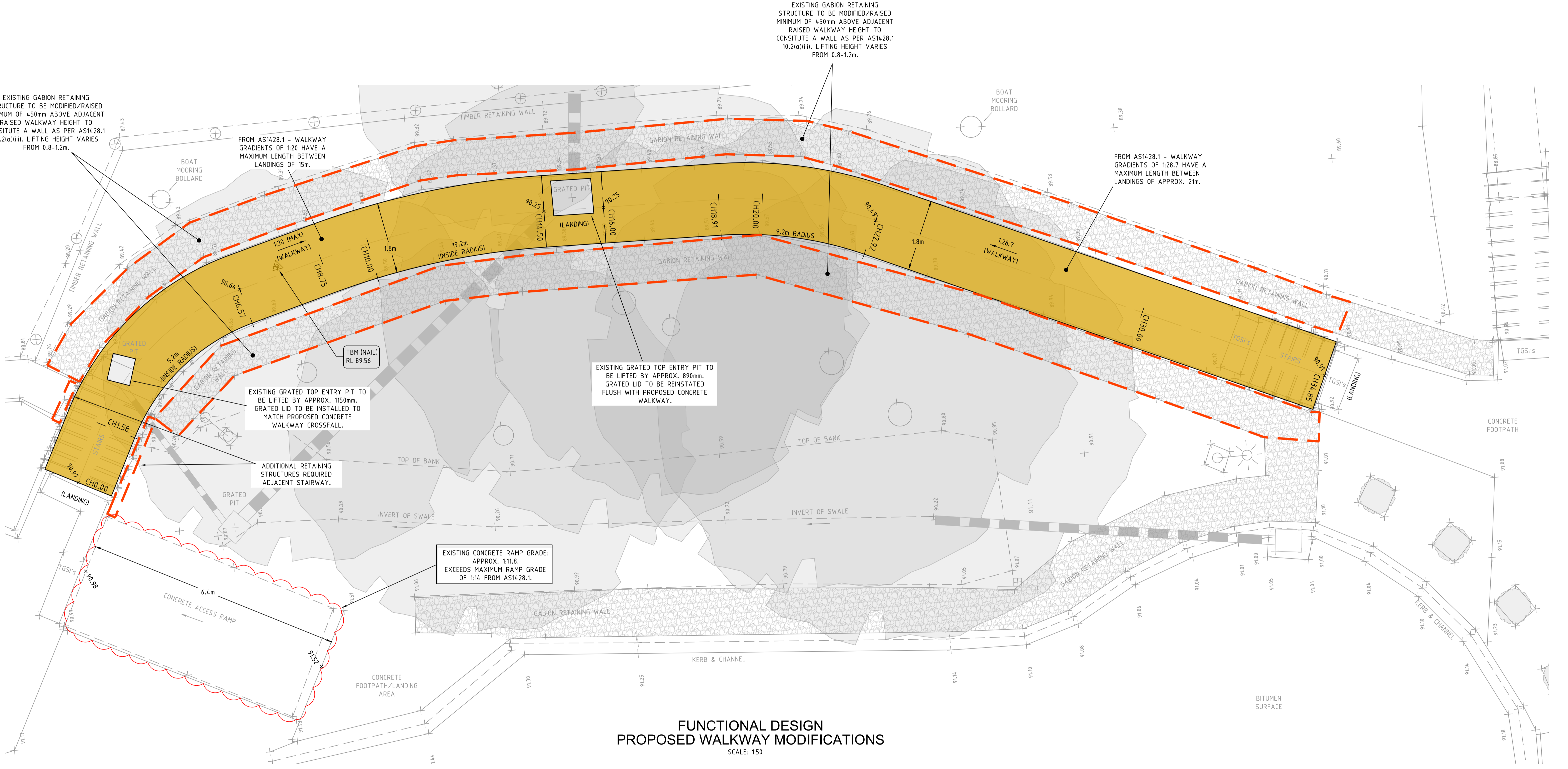

**FUNCTIONAL DESIGN
PROPOSED WALKWAY MODIFICATIONS**
SCALE: 1:50

RELEASE DETAILS				
NO.	DESCRIPTION	DATE	DOCUMENT STATUS	APP.
P2	PRELIMINARY	12.07.21	PRELIMINARY	RH
P1	PRELIMINARY	02.07.21	PRELIMINARY	RH

hec HEIL ENGINEERING CONSULTANTS PTY LTD

• Urban Development • Project Management •
• Infrastructure Design • Construction Administration •

SWAN HILL, VIC 3585 P 03 50332189
OCEAN GROVE, VIC 3226 P 03 52552220 www.heconsult.com.au

DESIGNED RH JULY 21
DRAWN RH JULY 21

N
(APPROX)

0 0.5 1.0 2.0
Scale 1:50

CAMPASPE SHIRE COUNCIL
FUNCTIONAL DESIGN - ACCESS RAMP & WALKWAY MODIFICATIONS

ECHUCA RIVERFRONT
ECHUCA, VIC

PROPOSED WALKWAY MODIFICATIONS

DRAWING NO.	21051_03
SHEET NO.	03 of 04
REVISION NO.	P2
A1 CAD:	21051_SD01-04.dwg

© Heil Engineering Consultants Pty Ltd.
THIS DOCUMENT IS COPYRIGHT AND MAY ONLY BE USED FOR THE PURPOSE FOR WHICH IT WAS COMMISSIONED.
UNAUTHORIZED USE PROHIBITED. ALL DIMENSIONS AND LEVELS TO BE CHECKED ON THE PROJECT BEFORE
COMMENCING ANY WORKS OR SHOP DRAWINGS. DRAWINGS NOT TO BE SCALED.

LEGEND

	EXISTING SURFACE
	DESIGN SURFACE

CONCEPT
NOT FOR CONSTRUCTION

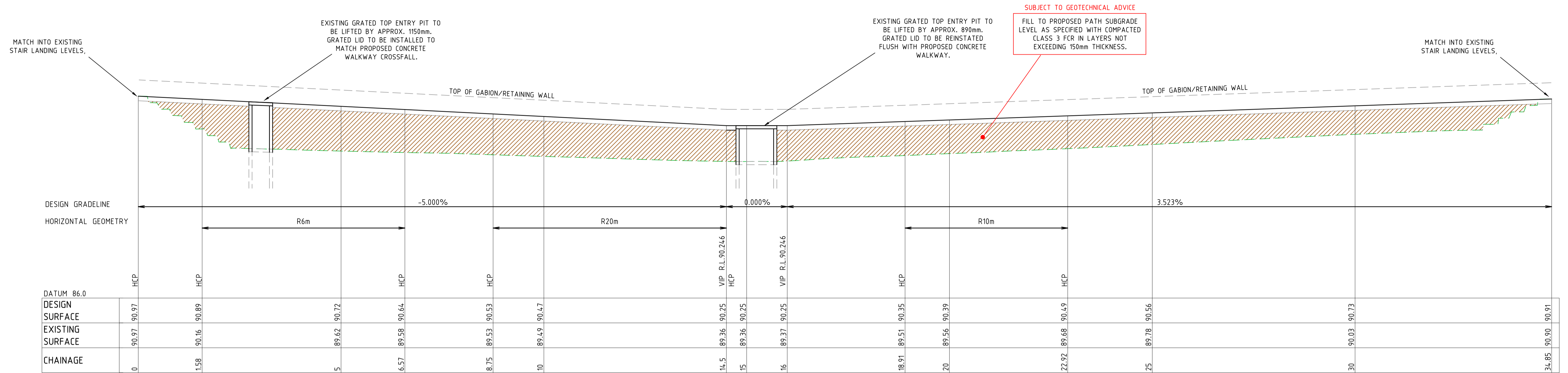

**FUNCTIONAL DESIGN
PROPOSED WALKWAY LONGITUDINAL SECTION
(PATH CENTRELINE)**

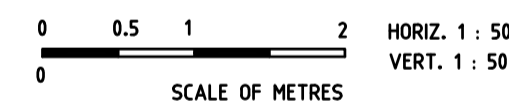

RELEASE DETAILS

NO.	DESCRIPTION	DATE	DOCUMENT STATUS	APP.
P2	PRELIMINARY	12.07.21	PRELIMINARY	RH
P1	PRELIMINARY	02.07.21	PRELIMINARY	RH



SWAN HILL, VIC 3585 P. 03 50332189
OCEAN GROVE, VIC 3226 P. 03 52552220 www.heconsult.com.au
DESIGNED RH JULY 21
DRAWN RH JULY 21

0 Scale AS NOTED

CAMPASPE SHIRE COUNCIL
FUNCTIONAL DESIGN - ACCESS RAMP & WALKWAY MODIFICATIONS

ECHUCA RIVERFRONT
ECHUCA, VIC
PROPOSED WALKWAY LONGITUDINAL SECTION

DRAWING NO. 21051_04
SHEET NO. 04 of 04

REVISION NO. P2
A1
CAD: 21051_SD01-04.dwg

© Heil Engineering Consultants P/L
THIS DOCUMENT IS COPYRIGHT AND MAY ONLY BE USED FOR THE PURPOSE FOR WHICH IT WAS COMMISSIONED.
UNAUTHORISED USE PROHIBITED. ALL DIMENSIONS AND LEVELS TO BE CHECKED ON THE PROJECT BEFORE
COMMENCING ANY WORKS OR SHOP DRAWINGS. DRAWINGS NOT TO BE SCALED.